

## Gearbox + Motor

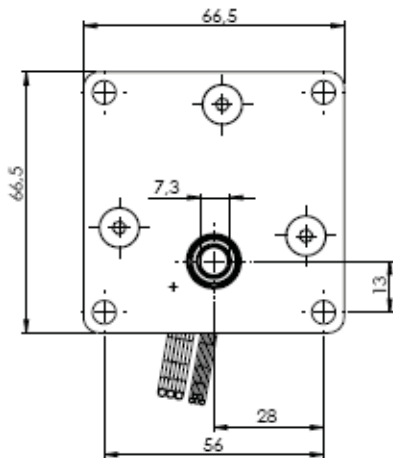

**Note:** Pole (+): left side, view output shaft.

Model	L
BG42x30	80
BG42x15	65

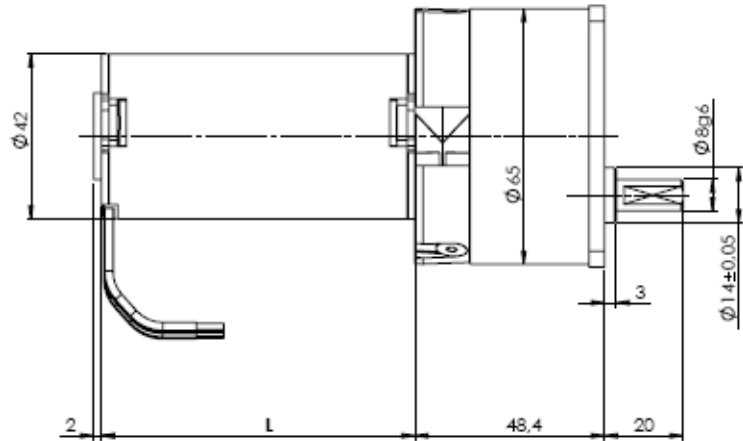

# KT50

## TECHNICAL CHARACTERISTICS

High endurance gearbox for heavy duty continuous workload in any position, at room temperature from -15 to 50°C, with **torque load up to 5 Nm, steady load.**

- **Box.** Made of die-cast Zamak with a tubular aluminium cover and aluminium frontal fixation flange.
- **Gear set.** Hobbed spur gear set with steel pinions and gear wheels, with case superficial heat anti-friction treatment. The intermediate gears turn on rectified hardened steel shafts, which are fixed to the box.
- **Output shaft.** Ø8 mm steel shaft, 20 mm usable length, with a flat. Incorporates and turns on ball bearings.
- **Output shaft load:**

Axial direction, pull or push	100 N ≈ 10 Kg.
Radial direction, at 10 mm from box	100 N ≈ 10 Kg.
- **Lubrication.** Lithium grade 2 grease.
- **Weight.** With maximal number of stages: 1.20 Kg.

**MOTOR COUPLING:**

- **Direct C.:** Dunker BG42 type, 12 or 24V.

■ **OPTIONAL:**

- Speed regulation with electronic controller.

**Avoid** impacts on the output shaft when assembling or disassembling parts on it, this could damage the gearbox.

Your special requests are welcome.

BRUSHLESS DC MOTORS MODEL: Dunker BG42														
			BG42x30 12V			BG42x30 24V			BG42x30KI 12V			BG42x30KI 24V		
Reduction ratio $i = X:1$	Stages	Torque factor	No load speed $n_0$ (r.p.m.)	Nominal Speed $n_N$ (r.p.m.)	Nominal Torque (N.m)	No load speed $n_0$ (r.p.m.)	Nominal Speed $n_N$ (r.p.m.)	Nominal Torque (N.m)	No load speed $n_0$ (r.p.m.)	Nominal Speed $n_N$ (r.p.m.)	Nominal Torque (N.m)	No load speed $n_0$ (r.p.m.)	Nominal Speed $n_N$ (r.p.m.)	Nominal Torque (N.m)
1,44	1	1,30	2909,72	2312,50	0,22	2854,17	2486,11	0,22	2986,11	2506,94	0,13	2861,11	2548,61	0,22
2,17	1	1,95	1930,88	1534,56	0,34	1894,01	1649,77	0,33	1981,57	1663,59	0,20	1898,62	1691,24	0,32
3,46	2	2,80	1210,98	962,43	0,48	1187,86	1034,68	0,48	1242,77	1043,35	0,28	1190,75	1060,69	0,47
4,79	2	3,88	874,74	695,20	0,67	858,04	747,39	0,66	897,70	753,65	0,39	860,13	766,18	0,64
9,28	2	7,52	451,51	358,84	1,30	442,89	385,78	1,29	463,36	389,01	0,76	443,97	395,47	1,25
12,88	2	10,43	325,31	258,54	1,80	319,10	277,95	1,78	333,85	280,28	1,05	319,88	284,94	1,73
15,07	3	10,99	278,04	220,97	1,90	272,73	237,56	1,88	285,34	239,55	1,11	273,39	243,53	1,82
19,54	3	14,24	214,43	170,42	2,46	210,34	183,21	2,44	220,06	184,75	1,44	210,85	187,82	2,36
29,19	3	21,28	143,54	114,08	3,68	140,80	122,64	3,64	147,31	123,67	2,15	141,14	125,73	3,53
40,49	3	29,52	103,48	82,24		101,51	88,42		106,20	89,16	2,98	101,75	90,64	

**NO LOAD SPEED/NOMINAL TORQUE**

Motor BG 42x30-12V= 4190 r.p.m./1,02Nm.

Motor BG 42x30-24V= 4110 r.p.m./1,52Nm.

Motor BG 42x30 KI-12V= 4300 r.p.m./0,288Nm.

Motor BG 42x30 KI-24V= 4120 r.p.m./0,445Nm.

**WARNING:** The load might reduce final speed up to 40%.**GEARBOX TIPS:**

**Noise:** noise level depends on load symmetry, location (avoid acoustic resonance), and rotation speed; the lower the speed on the input shaft (motor), the lower the noise.