

# Gearbox + Motor **KT80-CPB**

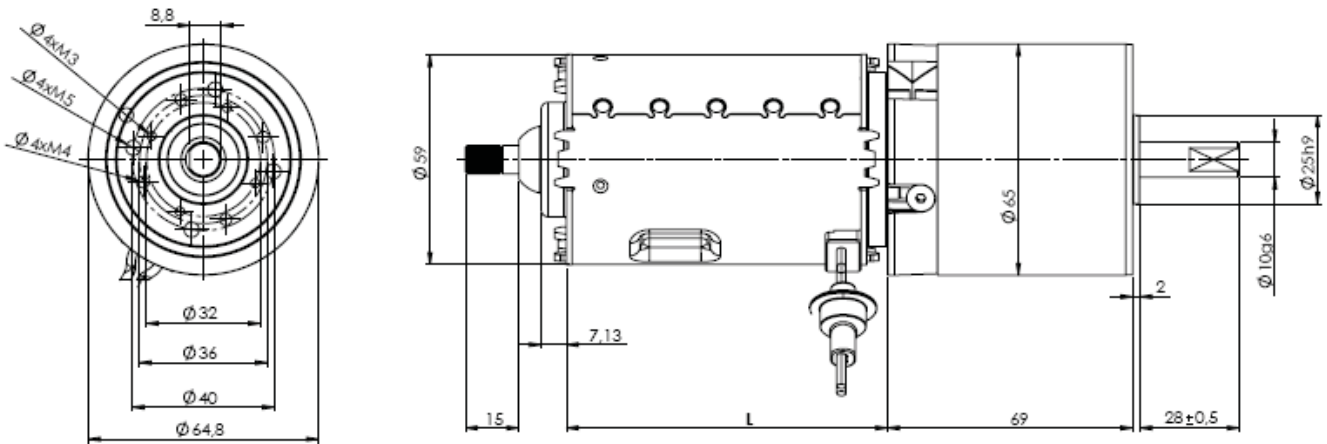

KT80

## TECHNICAL CHARACTERISTICS

High endurance gearbox for heavy duty continuous workload in any position, at room temperature from -15 to 50°C, with torque load up to 8 Nm, steady load.

- **Box.** Made of die-cast Zamak with a tubular aluminium cover. Several options for frontal mounting.
- **Gear set.** Hobbed spur gear set with steel pinions and gear wheels, with case superficial heat anti-friction treatment. The intermediate gears turn on rectified hardened steel shafts, which are fixed to the box.
- **Output shaft.** Ø10 mm steel shaft, 30 mm usable length, with a flat. Incorporates and turns on ball bearings.
- **Output shaft load:**

Axial direction, pull or push	500 N ≈ 50 Kg.
Radial direction, at 10 mm from box	350 N ≈ 35 Kg.
- **Lubrication.** Lithium grade 2 grease.
- **Weight.** With maximal number of stages: 1.41 Kg.

### MOTOR COUPLING:

- **Direct C.:** Bosch CPB 24V.

### ■ OPTIONAL:

- Ø8 shaft.
- Speed regulation with electronic controller.

Avoid impacts on the output shaft when assembling or disassembling parts on it, this could damage the gearbox.

Your special requests are welcome.

**DC MOTORS  
MODEL: BOSCH CPB**

**Bosch CPB 24V**

Reduction ratio $i = X:1$	Stages	Torque Factor	No load Speed $n_0$ (r.p.m.)	Nominal Speed $n_N$ (r.p.m.)	Nominal Torque (N.m)
4,43	2	3,59	981,94	835,21	0,80
6,68	2	5,41	651,20	553,89	1,21
10,65	3	7,76	408,45	347,42	1,74
14,78	3	10,77	294,32	250,34	2,42
28,63	3	20,87	151,94	129,24	4,68
39,71	3	28,95	109,54	93,18	6,49
46,45	4	30,48	93,65	79,66	6,83
60,26	4	39,54	72,19	61,40	
89,98	4	59,04	48,34	41,12	
124,81	4	81,89	34,85	29,65	

**NO LOAD SPEED/NOMINAL TORQUE**  
Motor CPB-24V= 4350 r.p.m./1,5Nm.

**WARNING:** The load might reduce final speed up to 40%.

**CURVES**

**Bosch CPB 24V**

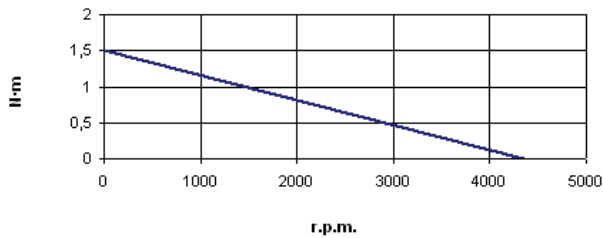

**GEARBOX TIPS:**

**Noise:** noise level depends on load symmetry, location (avoid acoustic resonance), and rotation speed; the lower the speed on the input shaft (motor), the lower the noise.